

Full Flow Quick-connects

QC2 Series

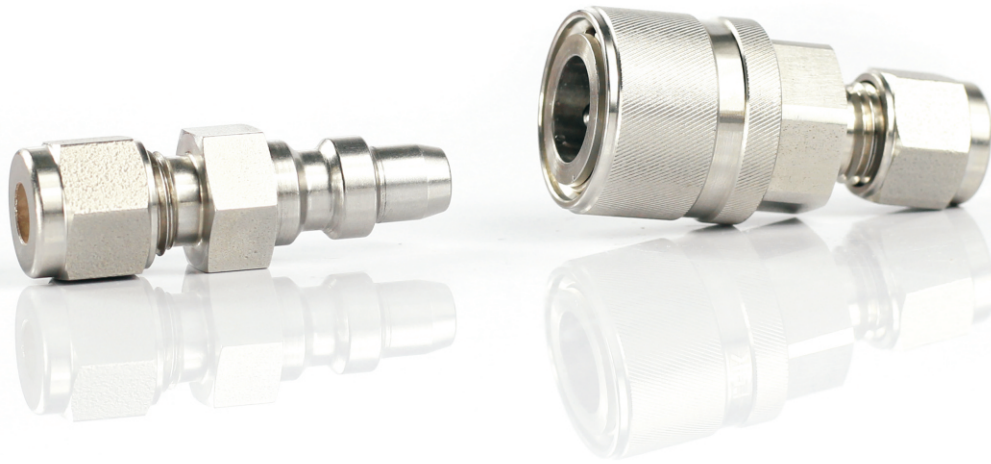

- ❖ Full flow without orifice restrictions
- ❖ Maximum working pressure up to 6000 psig (413 bar)
- ❖ Working temperature from -10°F to 400°F (-23°C to 204°C)
- ❖ O-ring is easily replaced without disassembling body
- ❖ Stainless steel and brass

Features

- ❖ Full flow without orifice restrictions
- ❖ Maximum working pressure up to 6000 psig (413 bar)
- ❖ Working temperature from -10°F to 400°F (-23°C to 204°C)
- ❖ O-ring is easily replaced without disassembling body
- ❖ Stainless steel and brass

Materials of Construction

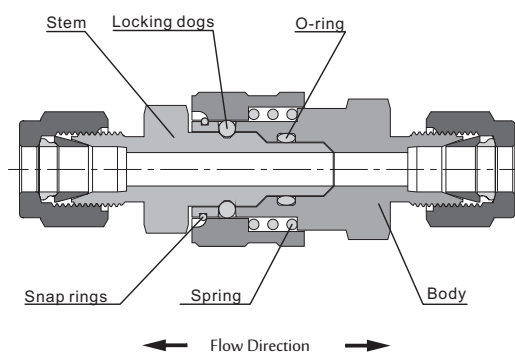

Component	Material	
	316 S.S.	Brass
Body, stem	316 S.S.	Brass C36000
O-rings	Fluorocarbon FKM	Buna N
Springs	316 S.S.	
Snap rings		
Locking ball		

Pressure-Temperature Ratings

Material	316 S.S.				Brass			
	-4 Series	-8 Series	-12 Series	-16 Series	-4 Series	-8 Series	-12 Series	-16 Series
Temperature °F (°C)	Pressure Rating psig (bar)							
Coupled								
-10 (23)	6000 (413)	6000 (413)	4000 (275)	4000 (275)	4000 (275)	3000 (206)	2000 (137)	2000 (137)
70 (20)	6000 (413)	6000 (413)	4000 (275)	4000 (275)	4000 (275)	3000 (206)	2000 (137)	2000 (137)
250 (121)	100 (6.8)	100 (6.8)	100 (6.8)	100 (6.8)	100 (6.8)	100 (6.8)	100 (6.8)	100 (6.8)
400 (204)	100 (6.8)	100 (6.8)	100 (6.8)	100 (6.8)	100 (6.8)	100 (6.8)	100 (6.8)	100 (6.8)

Stems

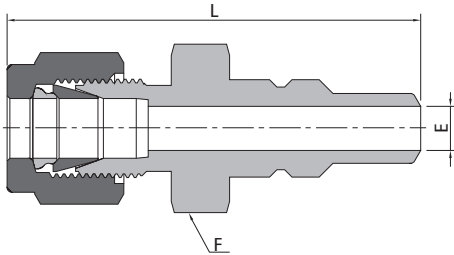

Tube Fitting

Tube Size in.	Basic Ordering Number	Flow Coefficient (Cv)	E in. (mm)	F in.	L in. (mm)
1/4	QC2-4-F4-S-	2.2	0.19 (4.8)	9/16	1.77 (45.0)
3/8	QC2-4-F6-S-	2.8	0.24 (6.1)	11/16	1.77 (45.0)
3/8	QC2-8-F6-S-	2.8	0.28 (7.1)	7/8	1.88 (47.8)
1/2	QC2-8-F8-S-	13.0	0.41 (10.4)	7/8	1.99 (50.5)
3/4	QC2-12-F12-S-	26.0	0.62 (15.7)	1 1/16	2.15 (54.6)
1	QC2-16-F16-S-	45.0	0.88 (22.4)	1 3/8	2.45 (62.2)
mm	Basic Ordering Number	Flow Coefficient (Cv)	(mm) in.	mm	(mm) in.
6	QC2-4-M6-S-	2.2	4.8 (0.19)	15	45.0 (1.77)
10	QC2-8-M10-S-	2.8	7.1 (0.28)	22	48.5 (1.91)
12	QC2-8-M12-S-	13.0	9.5 (0.37)	22	51.3 (2.02)
20	QC2-12-M20-S-	26.0	15.7 (0.62)	30	54.6 (2.15)
25	QC2-16-M25-S-	45.0	22.4 (0.88)	36	63.5 (2.50)

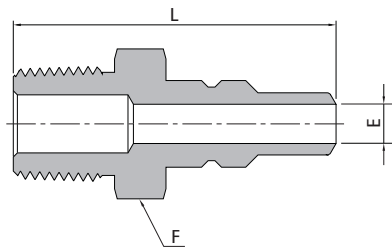

Male NPT

NPT Size	Basic Ordering Number	Flow Coefficient (Cv)	E in. (mm)	F in.	L in. (mm)
1/4	QC2-4-NPT4-S-	1.7	0.24 (6.1)	9/16	1.59 (40.4)
3/8	QC2-4-NPT6-S-	1.7	0.24 (6.1)	11/16	1.59 (40.4)
3/8	QC2-8-NPT6-S-	7.1	0.41 (10.4)	7/8	1.65 (41.9)
1/2	QC2-8-NPT8-S-	11.5	0.50 (12.7)	7/8	1.84 (46.7)
3/4	QC2-12-NPT12-S-	23.6	0.72 (18.3)	1 1/16	2.03 (51.6)
1	QC2-16-NPT16-S-	39.0	0.88 (22.4)	1 3/8	2.35 (59.7)

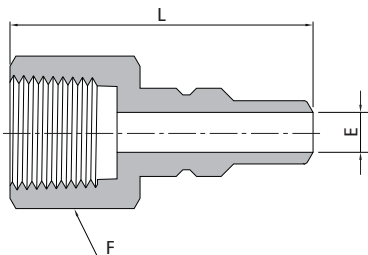

Female NPT

NPT Size	Basic Ordering Number	Flow Coefficient (Cv)	E in. (mm)	F in.	L in. (mm)
1/4	QC2-4-FNPT4-S-	1.7	0.24 (6.1)	3/4	1.60 (40.6)
3/8	QC2-4-FNPT6-S-	1.7	0.24 (6.1)	7/8	1.67 (42.4)
3/8	QC2-8-FNPT6-S-	7.1	0.41 (10.4)	1 1/16	1.59 (40.4)
1/2	QC2-8-FNPT8-S-	11.5	0.50 (12.7)	1 1/16	1.82 (46.2)
3/4	QC2-12-FNPT12-S-	23.6	0.72 (18.3)	1 5/16	2.08 (52.8)
1	QC2-16-FNPT16-S-	39.0	0.88 (22.4)	1 5/8	2.49 (63.2)

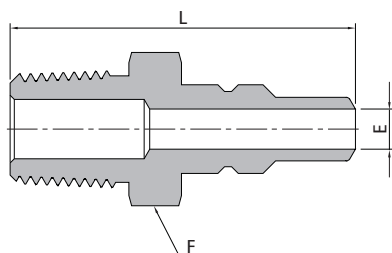

Male BSPT

BSPT Size	Basic Ordering Number	Flow Coefficient (Cv)	E in. (mm)	F in.	L in. (mm)
1/4	QC2-4-MBT4-S-	1.7	0.24 (6.1)	9/16	1.59 (40.4)
3/8	QC2-4-MBT6-S-	1.7	0.24 (6.1)	11/16	1.59 (40.4)
3/8	QC2-8-MBT6-S-	7.1	0.41 (10.4)	7/8	1.65 (41.9)
1/2	QC2-8-MBT8-S-	11.5	0.50 (12.7)	7/8	1.84 (46.7)
3/4	QC2-12-MBT12-S-	23.6	0.72 (18.3)	1 1/16	2.03 (51.6)
1	QC2-16-MBT16-S-	39.0	0.88 (22.4)	1 3/8	2.35 (59.7)

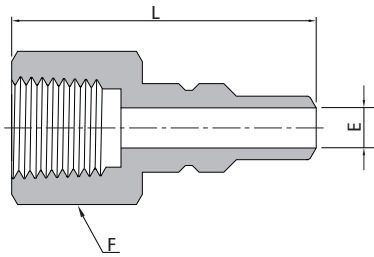

Female BSPT

BSPT Size	Basic Ordering Number	Flow Coefficient (Cv)	E	F	L
			in. (mm)	in.	in. (mm)
1/4	QC2-4-FBT4-S-	1.7	0.24 (6.1)	3/4	1.60 (40.6)
3/8	QC2-4-FBT6-S-	1.7	0.24 (6.1)	7/8	1.67 (42.4)
3/8	QC2-8-FBT6-S-	7.1	0.41 (10.4)	1 1/16	1.59 (40.4)
1/2	QC2-8-FBT8-S-	11.5	0.50 (12.7)	1 1/16	1.82 (46.2)
3/4	QC2-12-FBT12-S-	23.6	0.72 (18.3)	1 5/16	2.08 (52.8)
1	QC2-16-FBT16-S-	39.0	0.88 (22.4)	1 5/8	2.49 (63.2)

Bodies

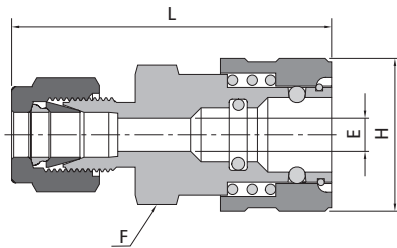

Tube Fitting

Tube Size	Basic Ordering Number	E	F	H	L
		in. (mm)	in.	in. (mm)	in. (mm)
1/4	QC2-4-F4-B-	0.19 (4.8)	11/16	0.87 (22.1)	1.80 (45.7)
3/8	QC2-4-F6-B-	0.28 (7.1)	11/16	0.87 (22.1)	1.81 (46.0)
3/8	QC2-8-F6-B-	0.28 (7.1)	1 1/16	1.30 (33.0)	2.17 (55.1)
1/2	QC2-8-F8-B-	0.47 (11.9)	1 1/16	1.30 (33.0)	2.23 (56.6)
3/4	QC2-12-F12-B-	0.62 (15.7)	1 1/2	1.66 (42.2)	2.45 (62.2)
1	QC2-16-F16-B-	0.88 (22.4)	1 11/16	1.88 (47.8)	2.75 (69.9)
mm	Basic Ordering Number	(mm) in.	mm	(mm) in.	(mm) in.
6	QC2-4-M6-B-	4.8 (0.19)	18	22.1 (0.87)	45.7 (1.80)
10	QC2-8-M10-B-	7.1 (0.28)	27	33.0 (1.30)	55.9 (2.20)
12	QC2-8-M12-B-	10.4 (0.41)	27	33.0 (1.30)	57.4 (2.26)
20	QC2-12-M20-B-	15.9 (0.63)	38	42.2 (1.66)	63.5 (2.50)
25	QC2-16-M25-B-	21.8 (0.86)	46	47.8 (1.88)	70.0 (2.76)

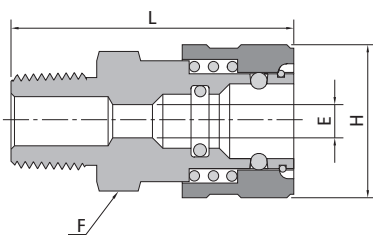

Male NPT

NPT Size	Basic Ordering Number	E	F	H	L
		in. (mm)	in.	in. (mm)	in. (mm)
1/4	QC2-4-NPT4-B-	0.25 (6.4)	11/16	0.87 (22.1)	1.57 (39.9)
3/8	QC2-4-NPT6-B-	0.37 (9.4)	11/16	0.87 (22.1)	1.57 (39.9)
3/8	QC2-8-NPT6-B-	0.41 (10.4)	1 1/16	1.30 (33.0)	1.83 (46.5)
1/2	QC2-8-NPT8-B-	0.50 (12.7)	1 1/16	1.30 (33.0)	2.08 (52.8)
3/4	QC2-12-NPT12-B-	0.72 (18.3)	1 1/2	1.66 (42.2)	2.33 (59.2)
1	QC2-16-NPT16-B-	0.88 (22.4)	1 11/16	1.88 (47.8)	2.65 (67.3)

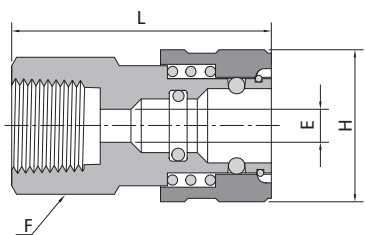

Female NPT

NPT Size	Basic Ordering Number	E	F	H	L
		in. (mm)	in.	in. (mm)	in. (mm)
1/4	QC2-4-FNPT4-B-	0.38 (9.7)	3/4	0.87 (22.1)	1.50 (38.1)
3/8	QC2-4-FNPT6-B-	0.38 (9.7)	7/8	0.87 (22.1)	1.63 (41.4)
3/8	QC2-8-FNPT6-B-	0.59 (15.0)	1 1/16	1.30 (33.0)	1.73 (43.9)
1/2	QC2-8-FNPT8-B-	0.63 (16.0)	1 1/16	1.30 (33.0)	1.73 (43.9)
3/4	QC2-12-FNPT12-B-	0.88 (22.4)	1 1/2	1.66 (42.2)	1.89 (48.0)
1	QC2-16-FNPT16-B-	1.06 (26.9)	1 11/16	1.88 (47.8)	2.12 (53.8)

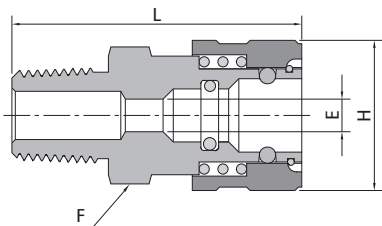

Male BSPT

BSPT Size	Basic Ordering Number	E	F	H	L
		in. (mm)	in.	in. (mm)	in. (mm)
1/4	QC2-4-MBT4-B-	0.25 (6.4)	11/16	0.87 (22.1)	1.57 (39.9)
3/8	QC2-4-MBT6-B-	0.37 (9.4)	11/16	0.87 (22.1)	1.57 (39.9)
3/8	QC2-8-MBT6-B-	0.41 (10.4)	1 1/16	1.30 (33.0)	1.83 (46.5)
1/2	QC2-8-MBT8-B-	0.50 (12.7)	1 1/16	1.30 (33.0)	2.08 (52.8)
3/4	QC2-12-MBT12-B-	0.72 (18.3)	1 1/2	1.66 (42.2)	2.33 (59.2)
1	QC2-16-MBT16-B-	0.88 (22.4)	1 11/16	1.88 (47.8)	2.65 (67.3)

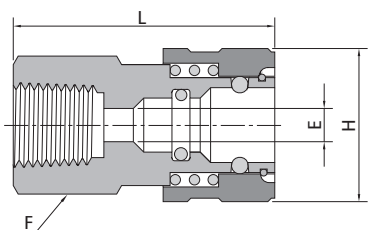

Female BSPT

BSPT Size	Basic Ordering Number	E	F	H	L
		in. (mm)	in.	in. (mm)	in. (mm)
1/4	QC2-4-FBT4-B-	0.38 (9.7)	3/4	0.87 (22.1)	1.50 (38.1)
3/8	QC2-4-FBT6-B-	0.38 (9.7)	7/8	0.87 (22.1)	1.63 (41.4)
3/8	QC2-8-FBT6-B-	0.59 (15.0)	1 1/16	1.30 (33.0)	1.73 (43.9)
1/2	QC2-8-FBT8-B-	0.63 (16.0)	1 1/16	1.30 (33.0)	1.73 (43.9)
3/4	QC2-12-FBT12-B-	0.88 (22.4)	1 1/2	1.66 (42.2)	1.89 (48.0)
1	QC2-16-FBT16-B-	1.06 (26.9)	1 11/16	1.88 (47.8)	2.12 (53.8)

Body Protector

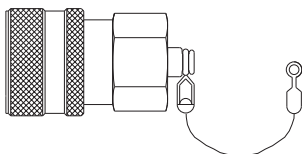

Series	Basic Ordering Number
-4	QC2-4-BP-
-8	QC2-8-BP-
-12	QC2-12-BP-
-16	QC2-16-BP-

Stem Protector

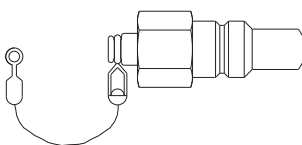

Series	Basic Ordering Number
-4	QC2-4-SP-
-8	QC2-8-SP-
-12	QC2-12-SP-
-16	QC2-16-SP-

❖ To order a protector, add material designator (316 or Brass) as a prefix to the basic ordering number.

Example: QC2-4-SP-316

How to Order

QC2 — 8 — F8 — BS — 316

Series	Size	End Connection Type	End Connection Size	Stem or Body	Body Material
QC2	4	FNPT Female NPT	4 1/4 in.	S Stem	316 316 S.S
	8	NPT Male NPT	6 3/8 in. or 6 mm	B Body	316L 316L S.S
	12	FBT Female BSPT	8 1/2 in. or 8 mm	BS Stem + Body	304 304 S.S
		MBT Male BSPT	10 5/8 in. or 10 mm		
	16	FMS Female ISO 261	12 3/4 in. or 12 mm		304L 304L S.S
		MS Male ISO 261 (for BG)	14 M14 x 1.5		
		F Fractional Tube Fitting	16 1 in. or 16 mm		BR Brass
		M Metric Tube Fitting			
		MT Metri Tube Adapter			
		FT Fractional Tube Adapter			